



# Automotive & Industrial Family of Products



- ISOBIN™ 4547-25
- ISOBIN™ 4547-30
- ISOBIN™ 4547-33
- EUROBIN™ 1210-597
- EUROBIN™ 1210-860
- EUROBIN™ 1210-980
- EUROBIN™-DS717
- EUROBIN™-DS980
- EUROBIN™-DS1100
- EUROBIN™-EL1300
- EUROBIN™-EL1400
- EUROBIN™-EL1600
- EUROBIN™-EL2000

Returnable transport packaging designed to optimize the global supply chain.

# IsoBin™ Family

## Sustainable Supply Chain Solutions



### Features

---

25% lighter than standard foldable large containers

---

2000 lb (900kg) capacity

---

IsoBins and EuroBins are a fully sustainable returnable trip packaging, made with a polypropylene resin which is 100% recyclable to reduce your carbon footprint

---

Patented triple wall base is durable and impact-resistant to reduce product damage

---

The EuroBin 980 can be stacked 6 high when stored fully loaded with product or 3 high when they are being transported. When folded, it can be stacked 10 high in a European Mega Trailer.

---

Passed UN9 HAZMAT testing at both US and European independent test laboratories.

---

All bins available in UL94-V2 rated flame-resistant resin

---

Easy to handle with universal reach through latches

---

IsoBins and EuroBins are designed with safety in mind; they have a unique interlocking foot design for safer and more reliable stacking

---

Industry exclusive modular design allows for replaceable pallet straps, drop doors, and sidewalls.

---

Product identification is quick and easy with four label areas; RFID tags are optional

---

High Visibility pallet straps

---

Overlift lids and dust covers are available\*

---

\*Visit [iplmacro.com](http://iplmacro.com) for more details.

### Why Reusable?

Reusable containers create tremendous environmental advantages by conserving materials and resources, reducing waste, and lowering packaging costs.

### Why IPL Macro?

IsoBin and EuroBin have proven best in class durability and total cost of ownership.



In 2018 we joined 1% for the Planet – an organization whose members contribute at least one percent of their annual sales to environmental causes. As current members, we have pledged one percent of the revenue from our Hybrid line of bin products to environmental nonprofits.

[onepercentfortheplanet.org](http://onepercentfortheplanet.org)



### Specifications (Metric)

<b>IsoBin™</b>	Outside Dimensions (L x W x H) (mm)	Inside Dimensions (L x W) (mm)	Product Clearance (mm)	Collapsed Height (mm)	Weight Capacity (kg)	Weight (kg)	Internal Volume (M <sup>3</sup> )
IsoBin 25	1190 x 1140 x 635	1112 x 1061	465	330	907	43	.549
IsoBin 30	1190 x 1140 x 760	1112 x 1061	592	330	907	47	.698
IsoBin 33	1190 x 1140 x 845	1112 x 1061	675	330	907	51	.796

<b>EuroBin™</b>	Outside Dimensions (L x W x H) (mm)	Inside Dimensions (L x W) (mm)	Product Clearance (mm)	Collapsed Height (mm)	Weight Capacity (kg)	Weight (kg)	Internal Volume (M <sup>3</sup> )
EuroBin-597	1200 x 1000 x 597	1126 x 926	444	308	900	35	.463
EuroBin-860	1200 x 1000 x 860	1126 x 926	704	308	900	46	.734
EuroBin-980	1200 x 1000 x 980	1126 x 926	824	308	900	50	.859

### Specifications (US Standard)

<b>IsoBin™</b>	Outside Dimensions (L x W x H) (in)	Inside Dimensions (L x W) (in)	Product Clearance (in)	Collapsed Height (in)	Weight Capacity (lbs)	Weight (lbs)	Internal Volume (ft <sup>3</sup> )
IsoBin 25	47 x 45 x 25	43.8 x 41.8	18.3	13	2000	94	19.4
IsoBin 30	47 x 45 x 30	43.8 x 41.8	23.6	13	2000	103	25.0
IsoBin 33	47 x 45 x 33.3	43.8 x 41.8	26.6	13	2000	111	28.2

<b>EuroBin™</b>	Outside Dimensions (L X W X H) (in)	Inside Dimensions (L X W) (in)	Product Clearance (in)	Collapsed Height (in)	Weight Capacity (lbs)	Weight (lbs)	Internal Volume (ft <sup>3</sup> )
EuroBin-597	47 x 39 x 23.5	44.3 x 36.4	17.5	12	2000	78	16.3
EuroBin-860	47 x 39 x 33.8	44.3 x 36.4	27.7	12	2000	101	25.8
EuroBin-980	47 x 39 x 38.6	44.3 x 36.4	32.4	12	2000	110	30.2

### Common International Shipping Modes - Specifications

<b>IsoBin™</b>	US Domestic 53'		EU Mega Trailer		40' Hi Cube ISO	
	Full	Empty	Full	Empty	Full	Empty
IsoBin 25	112	224	96	216	80	160
IsoBin 30	84	224	96	216	60	160
IsoBin 33	84	224	72	216	60	160

<b>EuroBin™</b>	US Domestic 53'		EU Mega Trailer		40' Hi Cube ISO	
	Full	Empty	Full	Empty	Full	Empty
EuroBin-597	128	288	130	260	88	194
EuroBin-860	96	288	78	260	66	194
EuroBin-980	64	288	78	260	44	194

#### Dust Covers

	Weight (kg)
EuroBin	2.4
IsoBin	3.9

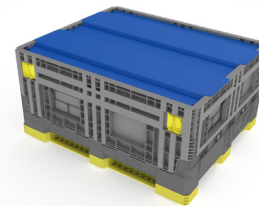

#### Notes

- All bins are made of FDA-regulated plastic material.
- Dimensions assume tolerance of ¼" (3mm). Volume capacities assume tolerance of 5% and tare weights assume tolerance of 4% unless noted otherwise.
- Please refer to the appropriate User Guide for information on the safe transportation, stacking and handling of IPL Macro products. The User Guides in PDF format are available online at [www.iplmacro.com](http://www.iplmacro.com) or call us at 1-800-845-6555.

# Introducing the EuroBin™ Extended Family



EuroBin™ "EL" Extended Length<sup>3</sup>

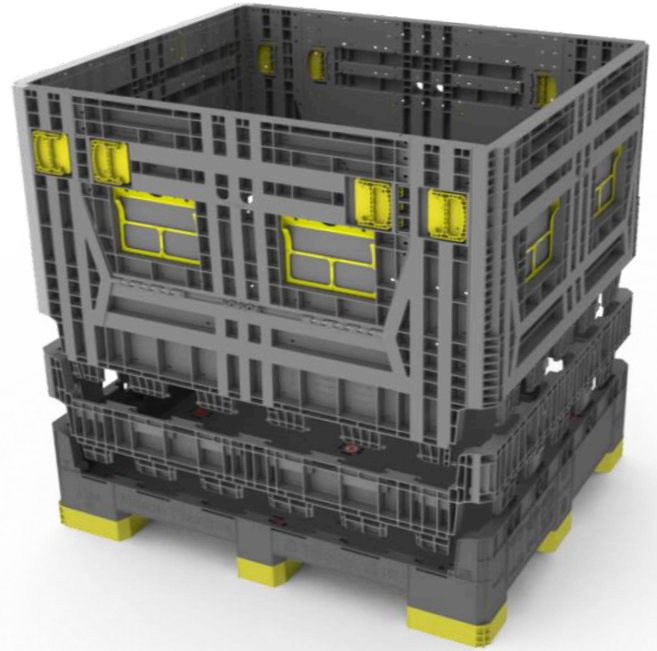

EuroBin™ "DS" Extended Height

## EuroBin Extended Family - Specifications (Metric)

	Outside Dimensions (L x W x H) (mm)	Inside Dimensions (L x W) (mm)	Product Clearance <sup>1</sup> (mm)	Weight Capacity (kg)
EuroBin-DS717	1200 x 1000 x 717	1126 x 926	561	900
EuroBin-DS980	1200 x 1000 x 980	1126 x 926	824	900
EuroBin-DS1100	1200 x 1000 x 1100	1126 x 926	944	900
EuroBin-EL1300	1300 x 1200 x (*)	1212 x 1126	*	600
EuroBin-EL1400	1400 x 1200 x (*)	1312 x 1126	*	600
EuroBin-EL1600	1600 x 1200 x (*)	1512 x 1126	*	600
EuroBin-EL2000	2000 x 1200 x (*)	1912 x 1126	*	600

## Common International Shipping Modes - Specifications

	US Domestic 53'		EU Mega Trailer		40' Hi Cube ISO	
	Open	Folded	Open	Folded	Open	Folded
EuroBin-DS717	96	192	104	182	66	194 <sup>2</sup>
EuroBin-DS980	96	192	78	182	44	194 <sup>2</sup>
EuroBin-DS1100	64	192	78	182	44	194 <sup>2</sup>
EuroBin-EL1300	72	216	60	200	30	80
EuroBin-EL1400	66	198	54	180	30	80
EuroBin-EL1600	60	216	48	160	30	80
EuroBin-EL2000	42	216	36	120	30	80

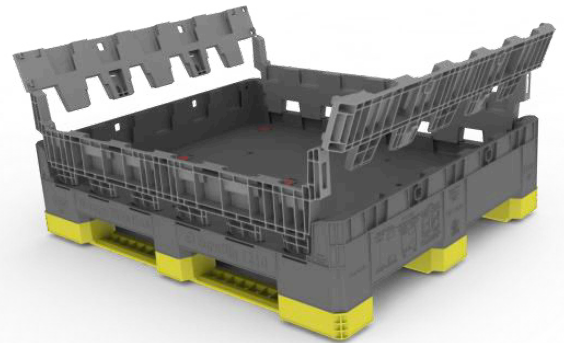

\*All standard EuroBin heights apply

<sup>1</sup>120mm dunnage space below hinge line

<sup>2</sup>Shipped with walls disassembled

<sup>3</sup>Extended length is a cut & welded fabricated bin



EN-13626



Europe: [rsalmon@macroplastics.com](mailto:rsalmon@macroplastics.com) +44.7860.202020  
 North America: [djakubiak@macroplastics.com](mailto:djakubiak@macroplastics.com) +1.502.647.5353